

TYPICAL DETAIL BASE PLATE SIZES FOR VARIOUS POSTS, SUBSTRATES & FIXINGS

**100X100 ALUMINIUM POST BASE PLATE  
CONCRETE SUBSTRATE**

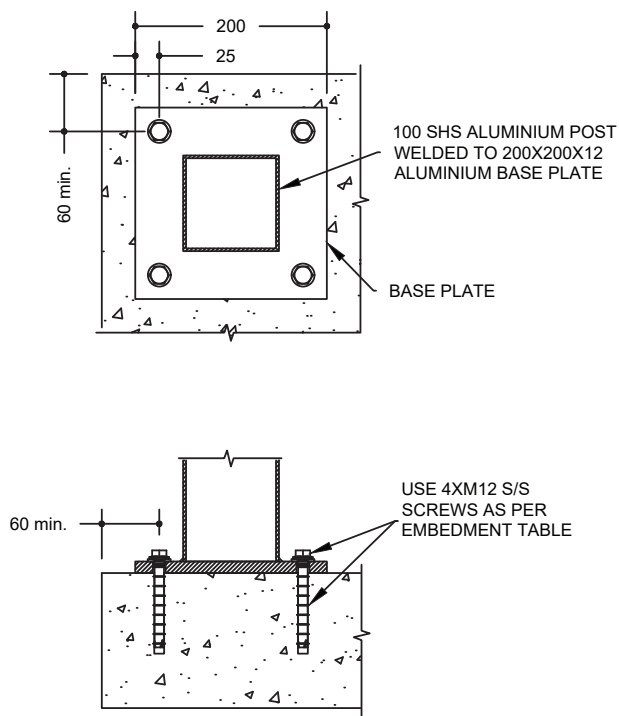

Type	Embedment	
	100x3 SHS	100x5 SHS
Chemset Threaded Rod	80	100
Masonry Screw	85	100

**150X150 ALUMINIUM POST BASE PLATE  
CONCRETE SUBSTRATE**

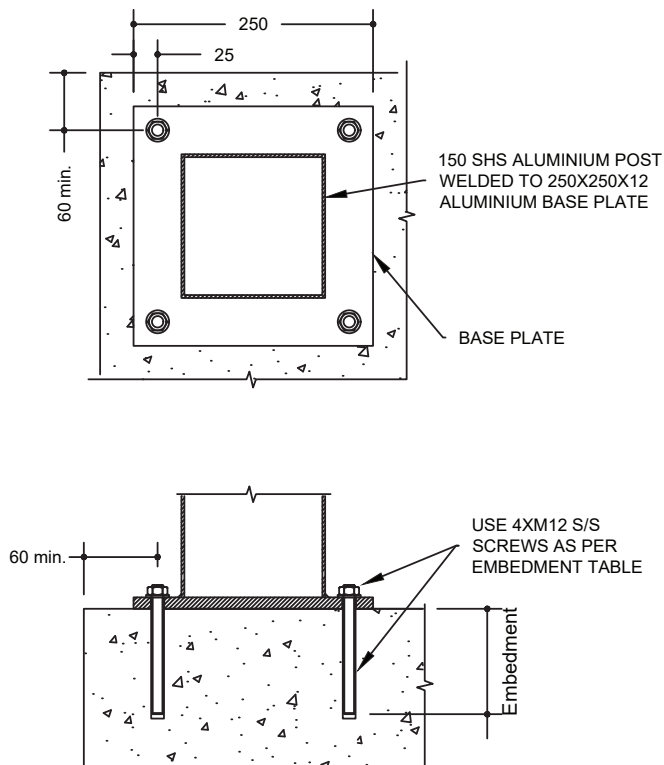

Type	Embedment	
	150x3 SHS	
Chemset Threaded Rod	110*	
Masonry Screw	120	

\*Ramset C6 Plus

**100X100 ALUMINIUM POST BASE PLATE  
TIMBER SUBSTRATE**

Type	Embedment	
	100x3 SHS	100x5 SHS
Coach	120	190
Spax	120	190

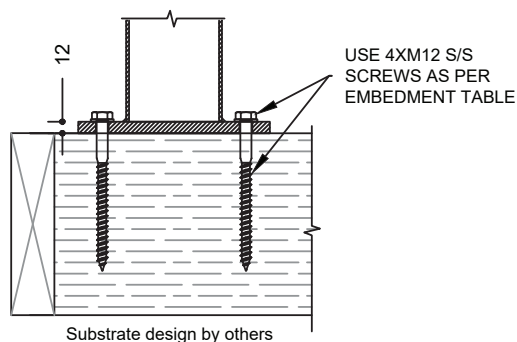

**150X150 ALUMINIUM POST BASE PLATE  
TIMBER SUBSTRATE**

Type	Embedment	
	150x3 SHS	
Coach	265	
Spax	260	

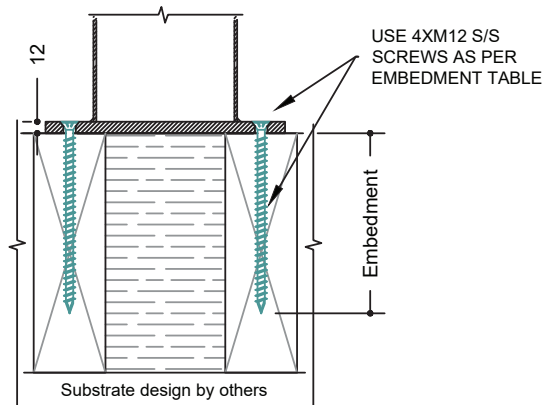

NOTE: ALL POST TO BASE PLATE WELDS MUST BE FULL PENETRATION BUTT WELDS ALL AROUND