

## TYPICAL DETAIL: BROMIC HEATING MOUNTING AND INSTALLATION OPTIONS

### MOUNTING OPTIONS:

- How your heater is mounted is as critical to the aesthetic design as it is to the functional output of the heater.
- Typically under a Louvretec Opening Roof the heater will be mounted to the underside of a structural beam.
- Where appropriate, the heater can also be mounted to the wall of the structure to which the Opening Roof is attached.
- Louvretec has custom brackets that also include a wiring conduit for under-beam mounting.
- Discuss with Louvretec which option is best suited for your installation.
- Discuss with Louvretec and your electrician the electrical feed requirements.



Wall mounted

### STANDARD HEATER FIXING DETAILS

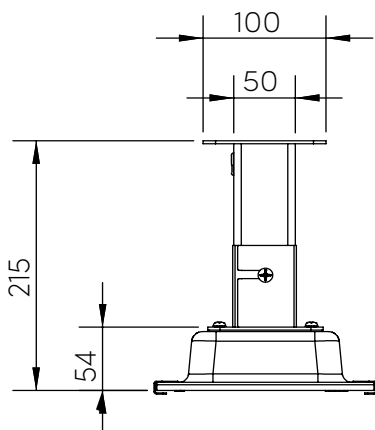

Beam on ceiling bracket

#### VERTICAL HEATER

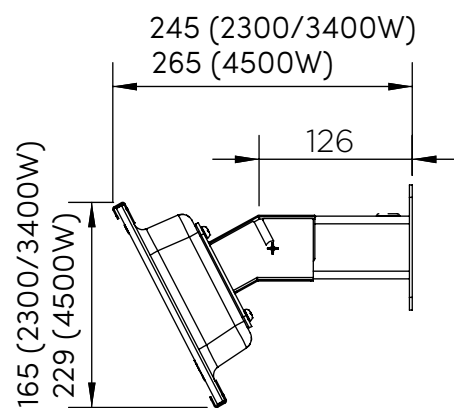

Wall bracket

#### HORIZONTAL HEATER

**HEATER BRACKET FITTING UNDER OPENING ROOF - NO WALL BEHIND**

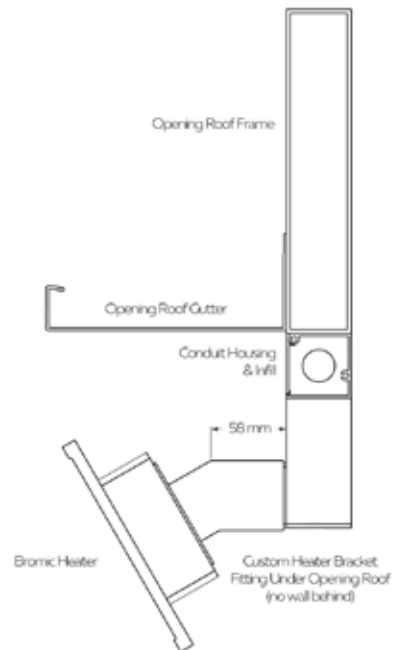
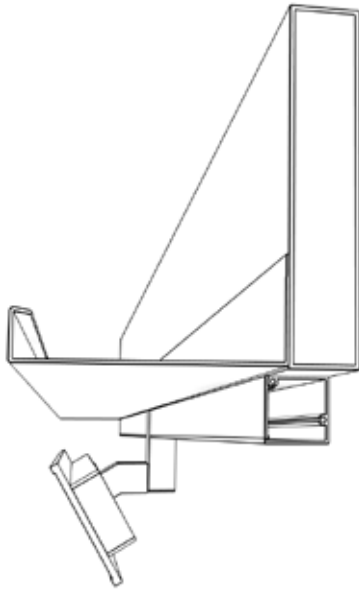

**HEATER BRACKET FITTING UNDER OPENING ROOF - WALL BEHIND**

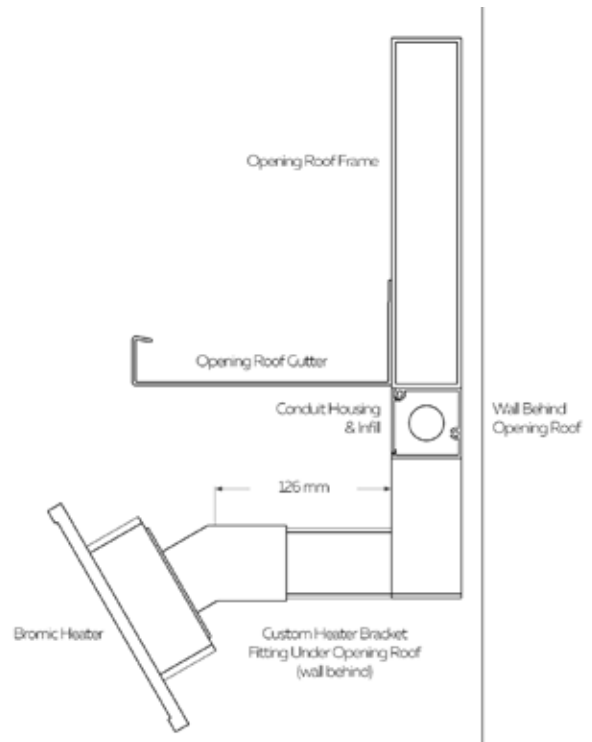
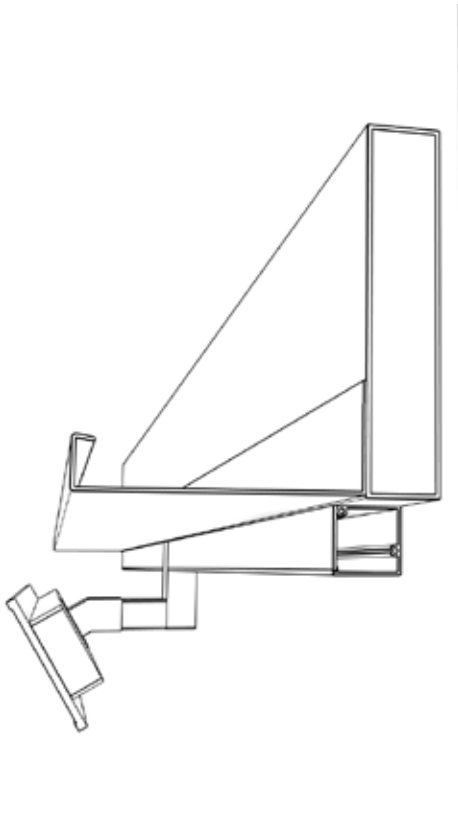

**TYPICAL DETAIL: BROMIC HEATING**  
**CUSTOM MOUNTING AND INSTALLATION OPTIONS**

HEATER BRACKET FITTING UNDER OPENING ROOF AND PROJECTING BEYOND GUTTER EXTRUSION  
THIS ALLOWS CLEARANCE FOR FIXING UP TO 3 OFF BOTTOM ROLLING SLIDETEC OR LOUVRED SHUTTERS

