



# the louvretec room



Gallery and Overview	9.02 - 9.05
Louvretec Room options	9.06 - 9.07
Step 1 Decking	9.08
Step 2 Structural Frames	9.09
Step 3 Opening Roof or Retract	9.10 - 9.11
Step 4 Infill Sides	9.12 - 9.14
Step 5 Finishing Touches: Lighting / Heating	9.15 - 9.16
Louvretec Room Warranty	9.17 - 9.18



Blurring the lines between indoor and outdoor spaces .....

## THE LOUVRETEC ROOM



## THE LOUVRETEC ROOM GALLERY



1. OPENING ROOF AND 135 HI SPAN LOUVRES 2. CLEAR PVC BLINDS 3. MESH BLINDS 4. SLIDING SHUTTERS





## THE LOUVRETEC ROOM

“The heart of the home”

*In modern architecture today everything has a flow to the outside.....*

Which is wonderful, however the outside is always changing and isn't always that hospitable.

A Louvretec Room genuinely gives you options to make the most out of whatever is going on outside all year round.

Roofs and walls can be opened, closed, retracted.....

Walls can be glass, mesh, louvres in many configurations - all of which can slide or raise should you so wish.

Lighting and heating can be added - all operable from a single hand held wireless remote controller

Be creative, have some fun, look and consider how this would work at your place.

## 5 BASIC STEPS

1. Decks: You will need a deck
2. Structural Frame: Add custom Louvretec engineered beams and posts
3. Opening Roof: Now you can choose between Opening only or fully Retractable
4. Infill options: Choose from Slidetec Frameless Glass, Outdoor Blinds or Louvred Shutters
5. The finishing touches: Add Lighting or Heating to suit

Please turn over for an easy-to-follow step x step guide.

## DECKS: STRUCTURAL FRAME | OPENING OR RETRACT ROOF



1. DECK



2. STRUCTURAL LOUVRETEC FRAME



3. OPENING ROOF



3. RETRACT ROOF





## INFILL OPTIONS | FINISHING TOUCHES



4. INFILL OPTIONS:  
SLIDETEC FRAMELESS GLASS SLIDERS



5. INFILL OPTIONS: OUTDOOR BLINDS



6. INFILL OPTIONS:  
LOUVRE SHUTTERS AND PANELS



7. FINISHING TOUCHES:  
LIGHTING AND HEATING



## STEP 1 DECKING

Most Louvretec Dealers don't do decks (so make sure you check this first with your local Louvretec Dealer) - this is the only part of the five steps not undertaken by Louvretec. You may have an existing deck, or the deck may be part of your new home build.

Decks are typically timber or composite such as eco-deck or concrete with tiled finish. Deck construction is critical as it forms the foundation to support your Louvretec Room structure. For decks under construction, discuss layout and fixing options with Louvretec.

### TIMBER DECKING



Make sure your deck complies with council requirements.

On existing decks additional structural support may be required. Posts can sit outside of deck or within deck structure with decking cut around post.

If the structural posts are fitting directly to the deck ensure there is adequate solid timber fixing at post connection points. Alternatively extend the posts to ground level and fix to a suitably engineered concrete pad.

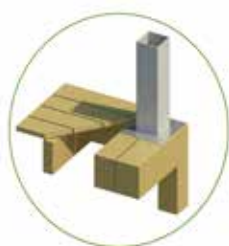

POSTS SITTING DIRECTLY ON TO DECK

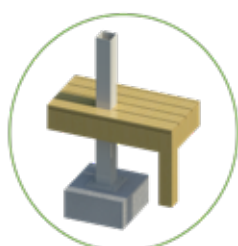

POSTS PROJECTED THROUGH DECK ON TO CONCRETE PAD

### CONCRETE DECKING

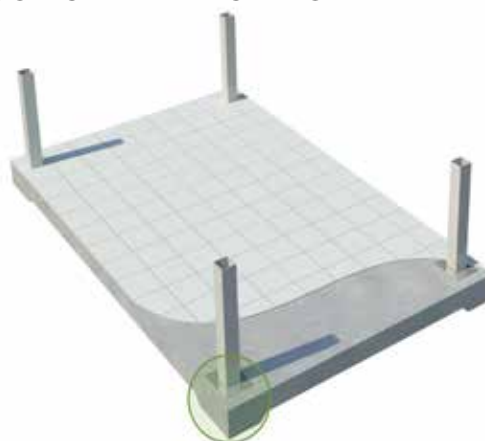

A typical 100mm concreted reinforced patio requires a concrete foundation under the post fixing points. Tiles or decorative surfaces can be laid to cover the base plate.



FIXING TO CONCRETE

louvretec structural  
Frames | Posts | Connections



## STEP 2 THE LOUVRETEC STRUCTURAL FRAME

- Louvretec offers a fully engineered structural aluminium frame system specifically designed for Outdoor Rooms.
- Beams & posts are custom designed to be structurally compliant to the specific wind zone.
- Louvretec structural frames provide for clean aesthetically pleasing lines and with regular cleaning, are virtually maintenance free. They are also designed to incorporate wall in-fills such as outdoor blinds, frameless sliding glass doors as well as a range of louvre panel infills.



TYPICAL FRAME LAYOUTS

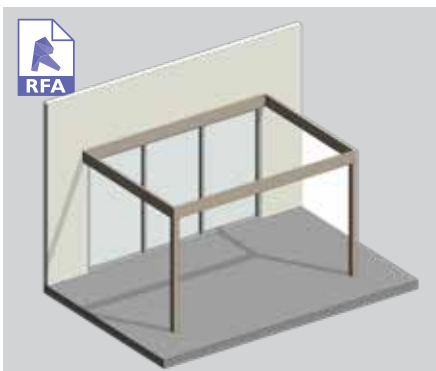

SIMPLY SUPPORTED

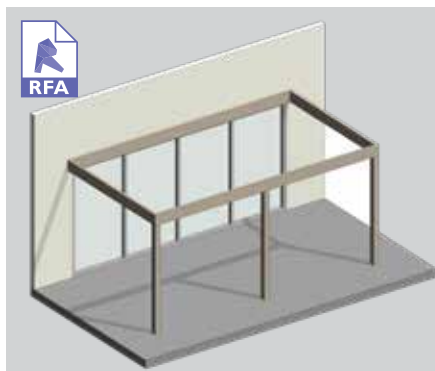

LENGTH EXTENDED - CONTINUOUS  
SPAN

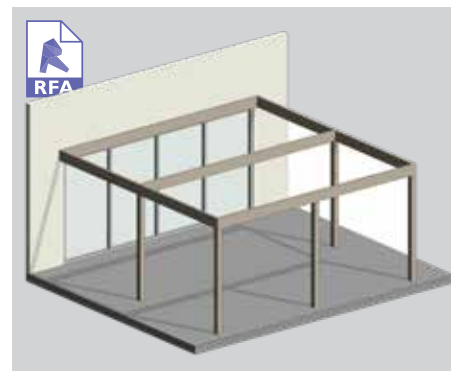

WIDTH EXTENDED

CONTACT YOUR NEAREST LOUVRETEC DEALER TO DISCUSS OPTIONS BEST SUITED FOR YOUR INSTALLATION

## STEP 3 1 OF 2 OPENING ROOF OPTION

### Opening Roof

We have a range of six different Opening Roofs to choose from. Offering a range of design styles, blade sizes and even a Translucent choice. Factors such as wind zones, and blade spans must be considered, with bigger spans and higher wind speeds requiring heavy duty blades.

Refer to Section 13 for Engineering Reports covering not only choice of blade but also structural frame and post sizes. A visit to your nearest Louvretec showroom is strongly recommended to see the actual range of options before deciding

REFER SECTION 2 FOR FULL DETAILS



### OPENING ROOF OPTIONS



180/30 SLIMLINE  
ROOF  
PGS 2.19 - 2.22



200/35 SLIMLINE  
ROOF  
PGS 2.23 - 2.26



220/35 SLIMLINE ROOF  
(RETRACT COMPATIBLE)  
PGS 2.27 - 2.30



220/45 ALPINE ROOF  
(RETRACT COMPATIBLE)  
PGS 2.31 - 2.34



200 SUBURBAN  
PGS 2.35 - 2.38 &  
SUBURBAN SOLAR PG 2.14



270 TRANSLUCENT  
ROOF  
PGS 2.39 - 2.42



## STEP 3 2 OF 2 RETRACT ROOF OPTION

### Retract Roof

Our new Somfy powered Retract Roof is also an option to consider. Blades can stack either all to one end or evenly to both ends giving clear open spaces above. Two new 220 Retract roof louvres have been designed that incorporates a number of innovative ideas.

Contact your Louvretec Dealer for full details. Truly putting another dimension into indoor/outdoor living

REFER SECTION 3 FOR FULL DETAILS



### RETRACT ROOF OPTIONS



220/35 SLIMLINE ROOF

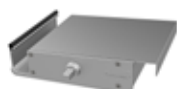

220/45 ALPINE ROOF



## STEP 4 1 OF 3 SLIDETEC FRAMELESS GLASS SLIDING PANELS

### Slidetec Frameless Glass Sliding Doors, Windows & Fixed Panels

Slidetec has been designed, developed and manufactured by Louvretec specifically to meet the harsh demands of the Australian and NZ climate.

Frameless Glass sliding Doors and Windows are an ideal infill option for a Louvretec Outdoor Room, providing wonderful protection without compromising your view.

REFER SECTION 5 FOR FULL DETAILS



#### CHOOSE FROM A WIDE RANGE OF PANEL CONFIGURATIONS

2 PANEL: USE 3 TRACK



LH SLIDING

RH SLIDING

3 PANEL: USE 3 TRACK

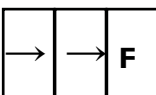

LH SLIDING

4 PANEL: USE 4 TRACK

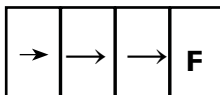

LH SLIDING

5 PANEL: USE 5 TRACK

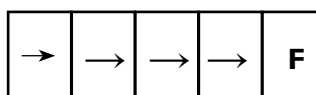

LH SLIDING

6 PANEL: USE 3 TRACK

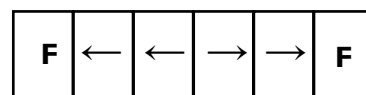

CENTRE PANELS LH & RH SLIDING

7 PANEL: USE 4 TRACK

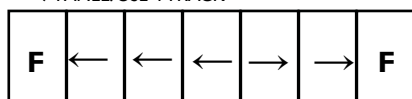

CENTRE SLIDING 3 LH, 2 RH AS SHOWN OR REVERSE (2 LH, 3 RH)

8 PANEL: USE 4 TRACK

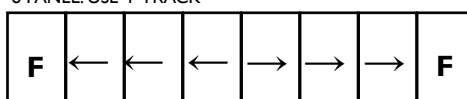

CENTRE PANELS LH & RH SLIDING

10 PANEL: USE 5 TRACK

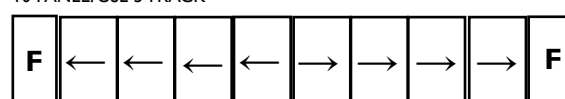

CENTRE PANELS LH & RH SLIDING

## STEP 4 2 OF 3 OUTDOOR BLINDS

### Outdoor Blinds

Outdoor Blinds are a popular option when considering closing in a wall of a Louvretec Room.

Outdoor Blinds provide great protection during every season, protecting from UV, wind, rain and dust.

Easy to operate, either pull down/push up, or motorised, speak to your local Louvretec Dealer regarding the best custom-made option for your installation.

REFER SECTION 6 FOR FULL DETAILS



A LARGE RANGE OF MESH DENSITY AND MESH COLOUR OPTIONS ARE AVAILABLE







## STEP 4 3 OF 3 LOUVRE SHUTTERS

### Louvre Shutters

Louvretec has a wide range of Operable and Fixed Shutters available, ideally suited for closing in Outdoor Room walls.

There is a range of Airfoil and Rectangular shaped louvre blades, ranging from 90mm to 150mm that fit within Fixed panels, Sliding or Bi-Folding panels.

Larger Fixed, Hand Operated or Motorised louvres ranging from 120mm to 200mm can also be incorporated into half or full walls providing aesthetically pleasing fit for purpose design options.

REFER SECTIONS 10 & 12 FOR FULL DETAILS



CHOOSE FROM A RANGE OF SLIDING / BIFOLDING LOUVRED DOORS OR WINDOWS





## STEP 5 1 OF 2 LIGHTING

### Lighting

Louvretec has developed the Light-tec custom range of premium lighting options, specifically to enhance a Louvretec Room, but equally as well suited for any Louvretec installation. Choose from three Light-tec options:

1. Continuous LED Pure Flow strip lighting to inside face of gutter. This popular option shines diffused light to the underside of the louvre blade.
2. Continuous LED Neon strip lighting to the front face of gutter. The ultra slim strip sits flush with the front face of the lighting clip providing seamless, continuous lighting to the inside of the Louvretec Room.
3. Underframe downlights

Discuss options that can be custom fitted to your Outdoor Room with your Louvretec Dealer.  
REFER SECTION 7 FOR FULL DETAILS



### 3 SIMPLE LIGHTING OPTIONS



INSIDE FACE GUTTER



OUTSIDE FACE GUTTER



DOWNLIGHTS

HEATING



## STEP 5 2 OF 2 FINISHING TOUCHES

### Heating

Heaters are a popular addition to an Outdoor Room. There is a wide range of heater options suitable for outdoor use.

Most Louvretec Dealers offer a suitable heater option.

In NZ, Louvretec offer Bromic infrared electric heaters as part of our Outdoor Room Package.

REFER SECTION 8 FOR FULL DETAILS



### BROMIC HEATERS

- Award winning design made of high quality stainless steel
- Superior technology allowing the heater to spread radiant heat evenly across a large area creating ideal comfort
- With a wide range of sizes available, find the ideal heater to suit your outdoor space
- Black and white colours available
- With a wide array of mounting options, Bromic offers solutions to compliment any decor and provide functionality for ambiance and comfort



## LOUVRETEC PRODUCT WARRANTY

### OPENING ROOFS - SUN LOUVRES - SHUTTERS

#### The Louvretec range of products:

All Louvretec branded products are designed and engineered in Australia & New Zealand by Louvretec to comply with relevant AS/NZS standards - refer to full Louvretec Engineering data Design Manual 2025 Section 13.

Louvretec has the most extensive range of outdoor sun shading/ outdoor living products available in Australasia, backed by a comprehensive network of Louvretec Dealers.



Most Louvretec products sold in Australia are made in Australia\*



Most Louvretec products sold in New Zealand are made in New Zealand\*

\*Some specialised products may only be made in Australia or in NZ and are shipped between each country.

#### The Authorised Louvretec Dealer Network:

Your Louvretec product will have been supplied and installed by your local Authorised Louvretec Dealer. All Louvretec Dealerships are privately owned, and the same Louvretec Dealer who supplied your Louvretec will also service your Louvretec.

Your Louvretec product has been "Engineered for Life" and we are committed to ensuring that happens.

#### LouvreCare:

Preventative maintenance and valet. Regular scheduled servicing by a LouvreCare team has real benefits. LouvreCare can vary between Dealerships - consult your local Louvretec Dealer.



*Engineered for Life*

**LouvreTec®**  
OPENING & RETRACT ROOFS / SUN LOUVRES / SHUTTERS

## LOUVRETEC PRODUCT WARRANTY

### OPENING ROOFS - SUN LOUVRES - SHUTTERS

#### warranty details

All product installed by Louvretec (excluding Outdoor Blinds - please refer separate warranty for this) , or an Authorised Louvretec Installer, is from date of invoice, fully warranted for the first two years. This warranty covers workmanship, louvres and all componentry, motors, switches and electronics with all labour costs included. In addition, from year two to end of year five, a warranty replacement of parts only applies for all motors, switches and electronics. Labour costs excluded. (Excludes any wiring and electrical connections done by others).

#### motorisation

Louvretec exclusively uses Somfy motors, switches and electronics. Somfy offers a 5-year warranty on all motors and electronics. Please contact Louvretec NZ or Somfy for a complete list of all terms and conditions.



#### product materials

All aluminium louvres and extrusions used in Louvretec's systems are manufactured in an ISO9002 quality assured environment to AS1866 & AS3902 standards. Marine grade T316 stainless steel is used for drive axles, with stainless steel componentry fixings being standard. Plastic injected moulded componentry is all UV stabilised

#### powdercoat finishes

A wide range of exterior powder coat finishes are available. Duralloy or equivalent is the standard finish supplied unless stated otherwise and this carries a 10 year film and colour integrity warranty as per the Dulux Powder and Industrial Coatings Warranty. If your project has used the Duratec powdercoat range please refer to the Dulux Powder and Industrial Coatings Warranty wording.

#### anodised finishes

The current specifications re anodised aluminium range from 12-20-25 microns depth. The greater the microns the better the protection. With regular cleaning anodised material will retain its original integrity for no less than 10 years.

#### fully engineered

Our louvre systems are designed to conform to New Zealand and Australian standards wind loadings. Full engineering details available on request.

#### cleaning

Periodic cleaning is essential to remove dirt, grime and accumulated salt deposits from both powder coated and anodised surfaces. Three steps for cleaning are:

- 1 Carefully remove any loose deposits with a wet sponge.
- 2 Use a soft non abrasive brush and a mild car cleaning detergent solution to remove dust, salt and other deposits.
- 3 Rinse off with clean fresh water.

#### product description

#### louvrecare

Louvrecare is a planned preventative maintenance and valet service designed to keep your Louvretec product clean and in good working order. Contact your Louvretec Dealer for full details.



#### effective from

Warranty effective from \_\_\_\_/\_\_\_\_/\_\_\_\_

Louvretec Representative \_\_\_\_\_ Print name \_\_\_\_\_

Site Address \_\_\_\_\_

LOUVRETEC NZ LTD

T +64 9 415 4949

Head office: 23c Douglas Alexander Parade, Albany 0632, Auckland New Zealand

E info@louvretect.co.nz

www.louvretect.com



